

## 17HD-C Series

Positional error:  $\pm 5\%$ ;  
 Working Temperature:  $-10^{\circ}\text{C}$ ~ $+40^{\circ}\text{C}$ ;  
 Temperature rise: 85K;  
 Insulation resistance: 100Mohm min 500V DC;  
 Insulation class: B.

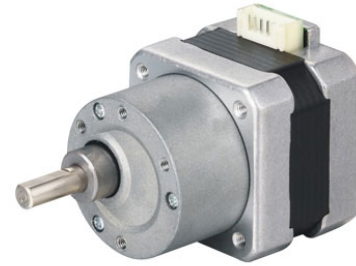

### Figure Dimensions

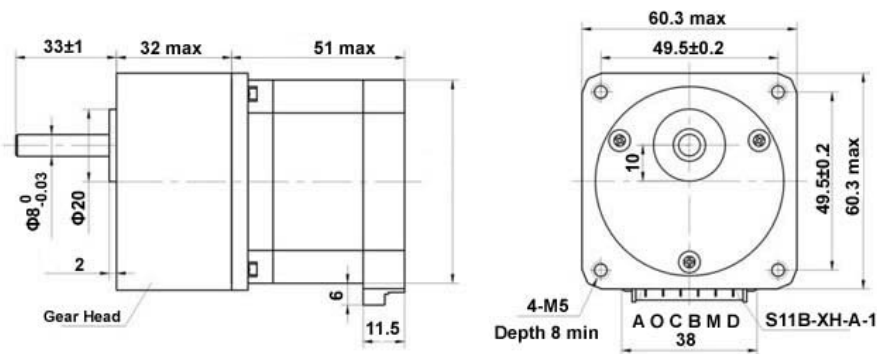

### Pulse-torque characteristics

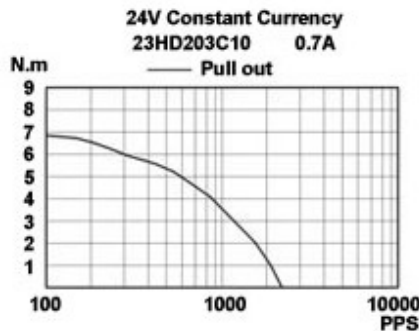

### Wiring Diagram

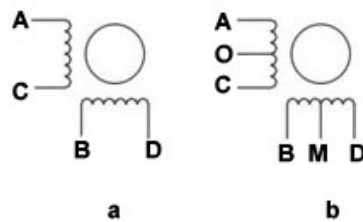

Code	Step angle	Rated current (A)	Resistance per phase ( $\Omega$ )	Inductance per phase (mH)	Holding torque (mN.m)	Wiring diagram	Motor mass (g)	Gear reduction rate
17HD202C10	$1.8^{\circ}$	0.5	30.0	60	2.0	a	0.35	1:10
17HD205C30	$1.8^{\circ}$	0.6	13.5	13.5	5.2	b	0.35	1:30
17HD003	$1.8^{\circ}$	0.4	30.0	37	150	b	0.20	1:30
17HD003N	$1.8^{\circ}$	0.4	30.0	37	150	b	0.20	1:30
17HD004	$1.8^{\circ}$	0.4	55.0	37	150	b	0.20	1:30
17HD005	$1.8^{\circ}$	0.4	22.0	30	150	b	0.20	1:30
17HD005N	$1.8^{\circ}$	0.6	22.0	28	150	b	0.20	1:30